



AVOL Model J3-2100 Motorised Stainless Steel Ball Valve

Electrically operated 2 way 316SS ball valve

Full bore 2 way 316 stainless steel ball valve, designed for automation with integrally cast ISO5211 actuator mounting platform fitted with direct mounted **J3** electric actuator. Supplied assembled and dry bench function tested. Full size range from 1/4" to 4".

Code

Function

- | | |
|----------------|--|
| J3-2103 | Standard power to open - power to close
- Stays put on mains failure |
| J3-2104 | Failsafe BSR - Battery Spring Return
- Fails to safe position using an internal battery |
| J3-2105 | Modulating DPS - Digital Positioning System |

Applications

Water, oil and many corrosive medias, subject to compatibility with wetted parts in contact with media. Actuators sized on a maximum differential pressure of 10 bar wet service, if the intended duty is above this differential, or dry (air or gas) call to check actuator sizing as a larger output actuator may be required.

Maximum working temperature of assembly is +70°C. If the intended duty is a higher temperature than this, select model **J3-2110** which has a mounting kit between the valve and actuator which uses air cooling to dissipate the heat away from the actuator.

Valve Specification

Body	CF8M Cast 316SS
Ball	CF8M Cast 316SS
Seats	RTFE
Pressure rating	UTI 2" 1000psi CWP
Valve temp limits	-20 to +200°C
Actuator temp limits	-20 to +70°C



J3 Actuator status light basic function:

Constantly lit LED

If the actuator is operating correctly with no faults, the LED shows a constantly lit light.

The LED flashes with 2 blinks

If the actuator has been left in 'manual' mode, the actuator's motor runs but doesn't drive the output shaft. After a pre-set time, the actuator knows that as the torque limiter has not activated and that the motor is running, it is in manual.

The LED flashes on/ off

When the actuator senses an impending valve jam, the electronic torque limiter is activated and on activation, repeatedly flashes the LED on and off.



Quick guide to the **J3** electric actuator standard features :

Highly visible LED light gives continuous actuator status indication.

J3 L - 12-24V AC/DC

J3 H - 80-240V AC/DC

Multi-voltage capable with auto-voltage sensing:

Torque output range:
25~95Nm Break
20~80Nm Reseat

Electronic torque limiter
Protects against valve jams

Anti-condensation heater

Manual override

All connections via external DIN plugs ~ no need to remove cover to connect

Volt free end of travel confirmation switches

IP65 weatherproof housing

CE marked

Traceable sequential serial numbering system

Optional failsafe kit (Battery Back-up) - actuator fails to safe position on power failure

Optional modulating kit with digital positioning system, either 0-10V or 4-20mA



AVOL Model J3-2100

DIMENSIONS

Electrically operated 3 pce stainless steel ball valve - Dimensions (to nearest mm)

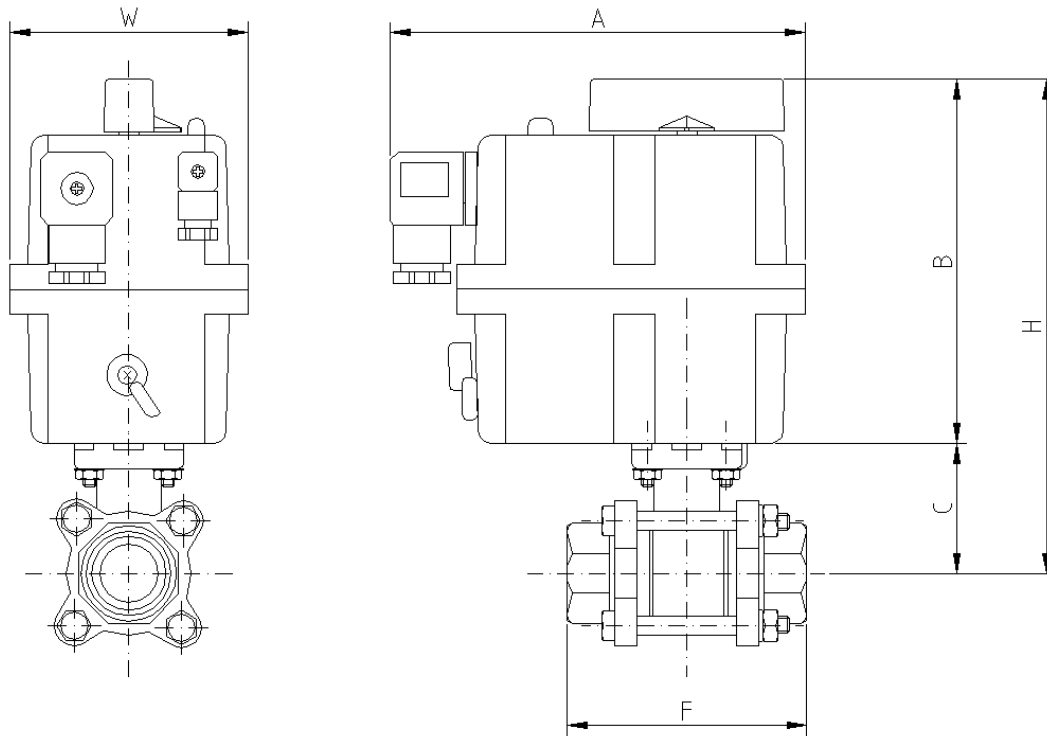

Dimensions remain unchanged for all versions (on-off, failsafe & modulating)

	Model	A	B	C	F	H	W	Kilos	Kv
1/4"	20	177	149	42	64	191	110	2.1	6.8
3/8"	20	177	149	42	64	191	110	2.1	6.8
1/2"	20	177	149	42	66	191	110	2.2	12.8
3/4"	20	177	149	48	76	197	110	2.3	29.1
1"	20	177	149	57	86	206	110	2.8	47.8
1 1/4"	20	177	149	61	103	210	110	3.4	72.6
1 1/2"	35	177	171	78	119	249	110	5.0	106.8
2"	55	177	196	85	131	281	110	6.6	213.7
2 1/2"	85	177	196	109	164	305	110	11.0	273.3
3"	85	177	196	118	183	314	110	14.3	495.3
4"	J2-140	235	214	133	236	154	254	26.7	871.1

Kv is in m³/hr, based on water at ambient temperature with a 1 bar pressure drop across the valve

Subject to alteration without notice. Uncontrolled copy, not subject to automatic updates