



## BRASS VALVES

### GENEBRE PART: 3070 REDUCED BORE 3 WAY L PORT BALL VALVE BSP



#### SPECIFICATIONS

1	Material: Brass
2	Threaded ends according to ISO228/1
3	Max working pressure 25 Bar at ambient temp
4	Temperature -10°C to +120°C
5	Reduced bore
6	Conforms to ECX Directive 97/23/EC
7	Hand operated with aluminium lever

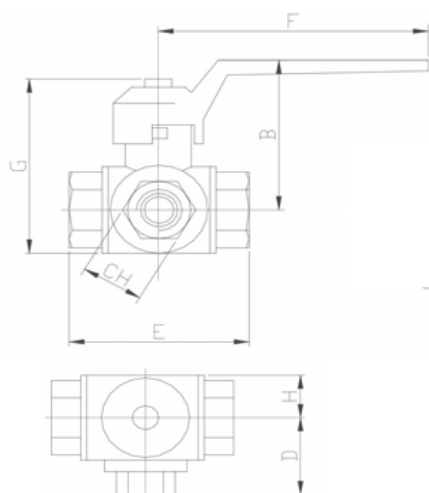

#### DIMENSIONS

AVOL REF	SIZE mm	B mm	D mm	F mm	H mm	Wt Kg
3070 02	1/4"	65	38.5	125	22	0.71
3070 03	3/8"	65	38.5	125	22	0.67
3070 04	1/2"	65	38.5	125	22	0.64
3070 05	3/4"	83	46.0	145	25	1.10
3070 06	1"	96	52.0	170	30	1.65
3070 07	1 1/4"	102	59.0	170	34	2.25
3070 08	1 1/2"	109	69.0	170	40	3.64
3070 09	2"	139	81.0	260	48	5.70

#### FLOW PATH OPTIONS

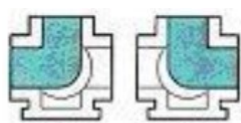
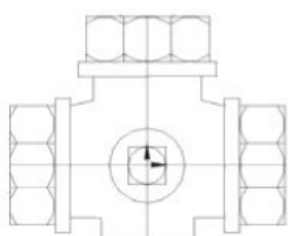

NORMAL FLOW CONFIGURATION  
= DIVERTING DUTY

