

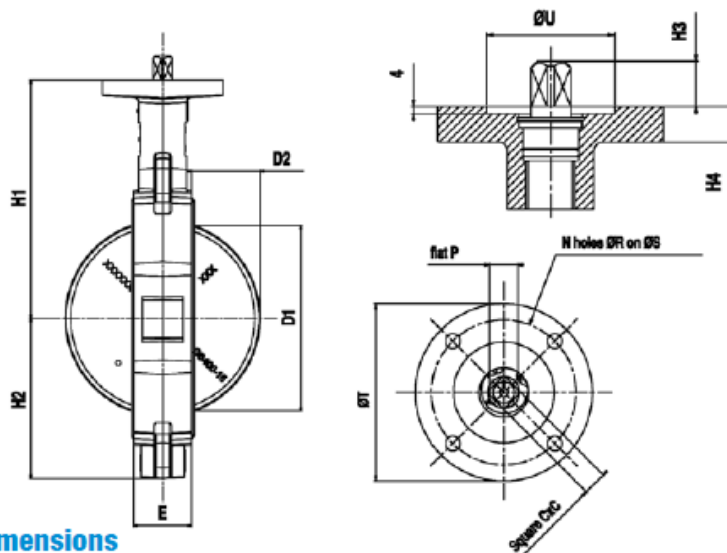

BUTTERFLY VALVES

LUGGED WRAS APPROVED BUTERFLY VALVE



WRAS
APPROVED
PRODUCT

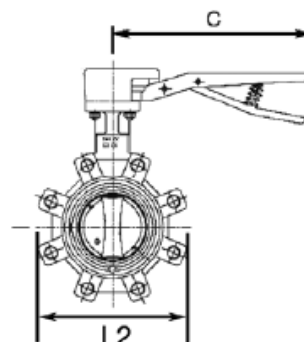

Dimensions

| Diameter | | Face to face | Overall dimensions | | | | Iso top according to ISO 5211 | | | | | | Square drive outlet | | | Travel of the disc | | Weight kg | |
|----------|-------|--------------|--------------------|-----|-------|-----|-------------------------------|---|------|-----|-----|----|---------------------|----|----|--------------------|-----|-----------|------|
| DN | NPS | E | C | L2 | H1 | H2 | H4 | N | ØR | ØS | ØT | ØU | N° | °C | H3 | Flat P | D1 | D2 | |
| 32/40 | 11/2 | 32 | 200 | 146 | 130 | 57 | 12 | 4 | 6,5 | 50 | 65 | 36 | F05 | 11 | 16 | 11 | 31 | 6,5 | 3.8 |
| 50 | 2 | 43 | 200 | 121 | 136 | 62 | 12 | 4 | 6,5 | 50 | 65 | 36 | F05 | 11 | 16 | 11 | 29 | 4,5 | 3.7 |
| 65 | 2 1/2 | 46 | 200 | 165 | 145 | 70 | 12 | 4 | 6,5 | 50 | 65 | 36 | F05 | 11 | 16 | 11 | 48 | 10 | 4.2 |
| 80 | 3 | 46 | 200 | 179 | 151 | 89 | 12 | 4 | 6,5 | 50 | 65 | 36 | F05 | 11 | 16 | 11 | 67 | 18 | 5.1 |
| 100 | 4 | 52 | 200 | 206 | 175 | 103 | 10 | 4 | 6,5 | 50 | 65 | 36 | F05 | 11 | 16 | 11 | 88 | 25 | 7.7 |
| 125 | 5 | 56 | 290 | 238 | 190 | 119 | 12 | 4 | 8,5 | 70 | 90 | 56 | F07 | 14 | 19 | 14 | 113 | 35 | 10.3 |
| 150 | 6 | 56 | 290 | 265 | 203 | 133 | 12 | 4 | 8,5 | 70 | 90 | 56 | F07 | 14 | 19 | 14 | 141 | 48 | 11.1 |
| 200 | 8 | 60 | 450 | 336 | 245,5 | 168 | 15,5 | 4 | 10,5 | 102 | 125 | 71 | F10 | 17 | 24 | 20 | 192 | 71 | 22.9 |
| 250 | 10 | 68 | 450 | 396 | 271 | 198 | 16 | 4 | 10,5 | 102 | 125 | 71 | F10 | 22 | 24 | 26 | 242 | 91,5 | 28.9 |
| 300 | 12 | 78 | 450 | 462 | 296 | 227 | 16 | 4 | 12,5 | 125 | 150 | 87 | F12 | 22 | 29 | 26 | 291 | 112 | 32.2 |
| 350 | 14 | 78 | | 497 | 305 | 248 | 16 | 4 | 12,5 | 125 | 150 | 87 | F12 | 27 | 29 | - | 331 | 132 | - |

Materials

| | |
|-------------|--|
| Body | Cast Iron |
| Disc | 316 S/S |
| Shaft | S/S 420 |
| Liner | EPDM / Nitril |
| Hand Lever | Ductile Iron |
| Temp. Range | EPDM -10 to +120°C NITRIL -5 to +85°C |



ALSO AVAILABLE IN STAINLESS STEEL